

HVL-F1000

SERVICE MANUAL

Ver 1.2 2004.07

HVL-F1000

US Model

Canadian Model

AEP Model



OVERALL ASSY, MAIN



ADAPTOR, ACCESSORY SHOE

SPECIFICATIONS

Guide number	Equivalent to 28
Recommended distance	1 to 8 m
Number of flashes	More than 200 times (at 20 °C)
Dimensions	About 68 95 92 mm (About 2 2/3 3 3/4 3 2/3 inches) (w/h/d) (Projections are not included in the dimensions)
Mass	About 190 g (6 2/3 oz.)
Supplied accessory	Shoe adapter (1) Pouch (1)

Design and specifications are subject to change without notice.

FEATURES

This appliance is exclusively for use on digital still cameras with the  (flash) terminal made by SONY.

It allows you to take photos with digital still cameras in dark or backlit conditions. It is provided with an automatic metering system.

CAUTION

- The flash cannot be used on camcorders.
- Misfiring sometimes occurs when the POWER switch is turned on and off continuously.
- When the flash is used in low-temperature conditions, battery performance is reduced. For example, the number of flashes becomes lower than that in room temperature (about 20 °C), and the charging time becomes longer. We recommend preparing new batteries. Note, however, that even batteries whose performance has dropped due to low temperatures are restored by returning them to room temperature.
- Do not leave or store the flash in temperatures that exceed 40 °C. Doing so might adversely affect the internal structure of video flash. (In particular, take care not to leave the flash in automobiles during summer.)

FLASH

SONY®

EXPLODED VIEW

ns : not supplied

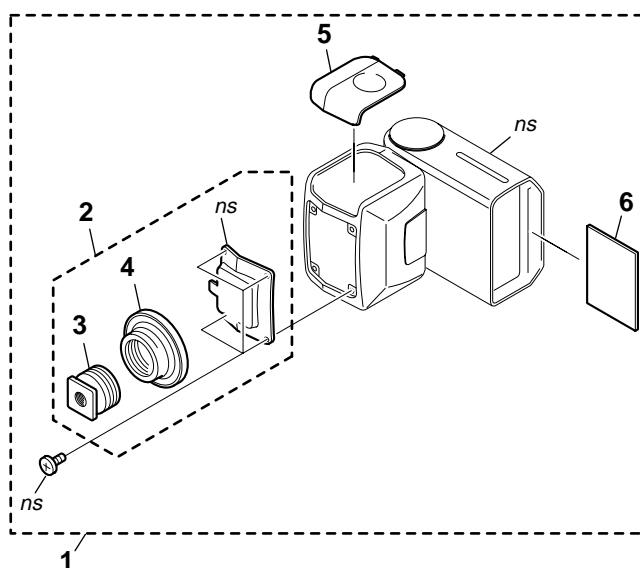

Ref. No.	Part No.	Description
1	A-7094-697-A	OVERALL ASSY, MAIN
2	X-3950-210-1	SHOE ASSY, COLD
3	2-532-809-01	HOLDER, SHOE
4	2-398-085-01	KNOB, FIXED
5	3-058-133-01	LID, BATTERY
6	3-058-144-01	PANEL, WIDE
	3-053-645-12	ADAPTOR, ACCESSORY SHOE
	3-970-278-01	POUCH

Ref. No.	Part No.	Description
	3-868-194-11	MANUAL, INSTRUCTION (ENGLISH,FRENCH,GERMAN)
	3-868-194-21	MANUAL, INSTRUCTION (DUTCH,POLISH,SPANISH) (AEP)
	3-868-194-31	MANUAL, INSTRUCTION (SWEDISH,ITALIAN,PORTUGUESE,RUSSIAN) (AEP)
	3-868-194-41	MANUAL, INSTRUCTION (ARABIC,SIMPLIFIED CHINESE,KOREAN) (AEP)

HVL-F1000

SONY®

HVL-F1000

US Model
Canadian Model
AEP Model

SERVICE MANUAL

Ver 1.1 2004.05

SUPPLEMENT-1

File this supplement-1 with the Service Manual.
(PV04-002)

Addition of the Service Parts.

PARTS LIST

 : Added portion.  : Changed portion.

OLD			NEW		
Ref. No.	Part No.	Description	Ref. No.	Part No.	Description
	A-7094-697-A	OVERALL ASSY, MAIN		A-7094-697-A	OVERALL ASSY, MAIN
				X-3950-210-1	SHOE ASSY, COLD
				2-398-085-01	KNOB, FIXED
				2-532-809-01	HOLDER, SHOE
	3-053-645-01	ADAPTOR, ACCESSORY SHOE		3-053-645-12	ADAPTOR, ACCESSORY SHOE
				3-058-133-01	LID, BATTERY
				3-058-144-01	PANEL, WIDE
	3-970-278-01	POUCH		3-970-278-01	POUCH

Revision History

Ver.	Date	History	Contents	S.M. Rev. issued
1.0	2000.04	Official Release	—	—
1.1	2004.05	Supplement-1 (PV04-002)	Addition of the Service Parts.	No
1.2	2004.07	Revised-1 (PV04-009)	Addition of Exploded view of the Service Parts. (SUPPLEMENT-1 (9-929-810-82) is included.)	Yes