

Domestic Appliances and Personal Care

Service Manual 4822 729 21606 is
herewith cancelled.

Service Manual

SAP coding 8843 541 99999
SAP coding 8843 542 99999

PRODUCT INFORMATION

HB541	:	8 x TL100W/Cleo
HB542	:	10 x TL100W/Cleo
Input power HB 541	:	approx. 920W
HB 542	:	approx. 1150W
Starter	:	S12
Ballast	:	100W/230V
Timer	:	60 mins Eaton
Radiation area	:	174 x 56 cm
Radiation distance	:	20 cm
Height adjustment	:	between 66-96 cm
Protecting goggles	:	HB072 - 4822 690 80147
Output UVX36 meter	:	HB541 >3.8 mW/cm ² at 20 cm
	:	HB542 >4.6 mW/cm ² at 20 cm

HINTS FOR REPAIRS

- By interchanging it can be found out whether starters, lamps or ballasts are defective.
If they are not, the internal wiring is to be checked, especially that on the tube holders.
- The snap-on connections of the wiring can be unlocked with a paper clip.
- The quick blackening of a tube-end points to a defective starter or a wiring fault.
- **Disassembly of radiation part**
Remove end cover (item 10).
Remove cover (item 9) and acrylic plate (item 11).
For removal of ballast or fan the pop rivets must be drilled out.
New parts have to be fixed with pop rivets 4.8 mm or blind-rivetting nuts M3 (no service items).

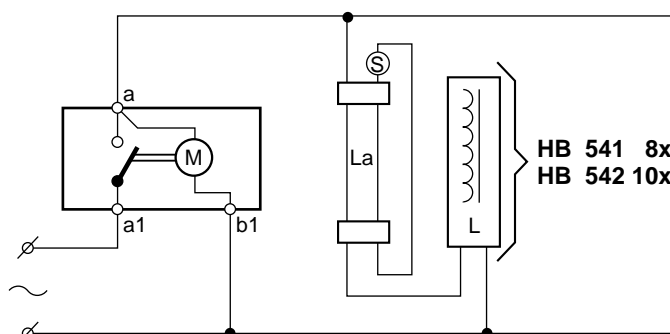

- Disassembly of gasspring (item 15)

Put solarium in highest position.
Fasten ornamental screw (item 16)
Now turn the stand and the radiation unit through so far that the legs of the stand and the radiation unit rest on the floor.
Remove the nut inside the stand tube.
Remove the ornamental screw and unlock the plastic guide block.
Separate the inner and outer stand part.
Remove the ornamental prop and the spring clip at the inner side of the stand and lift the pin out.
The gasspring can be taken out now.
Note: a new gasspring comes with plastic guide block, spring clip and ornamental prop.

Disassembly of hinge (item 13)

Remove the ornamental prop, spring clip and plastic ring.
Polish the shaft with abrasive paper to make the removal of guide blocks easier.
On assembly see to it that the cams of the spring clip rest in the groove on the shaft.

HB 541/A HB 542/A

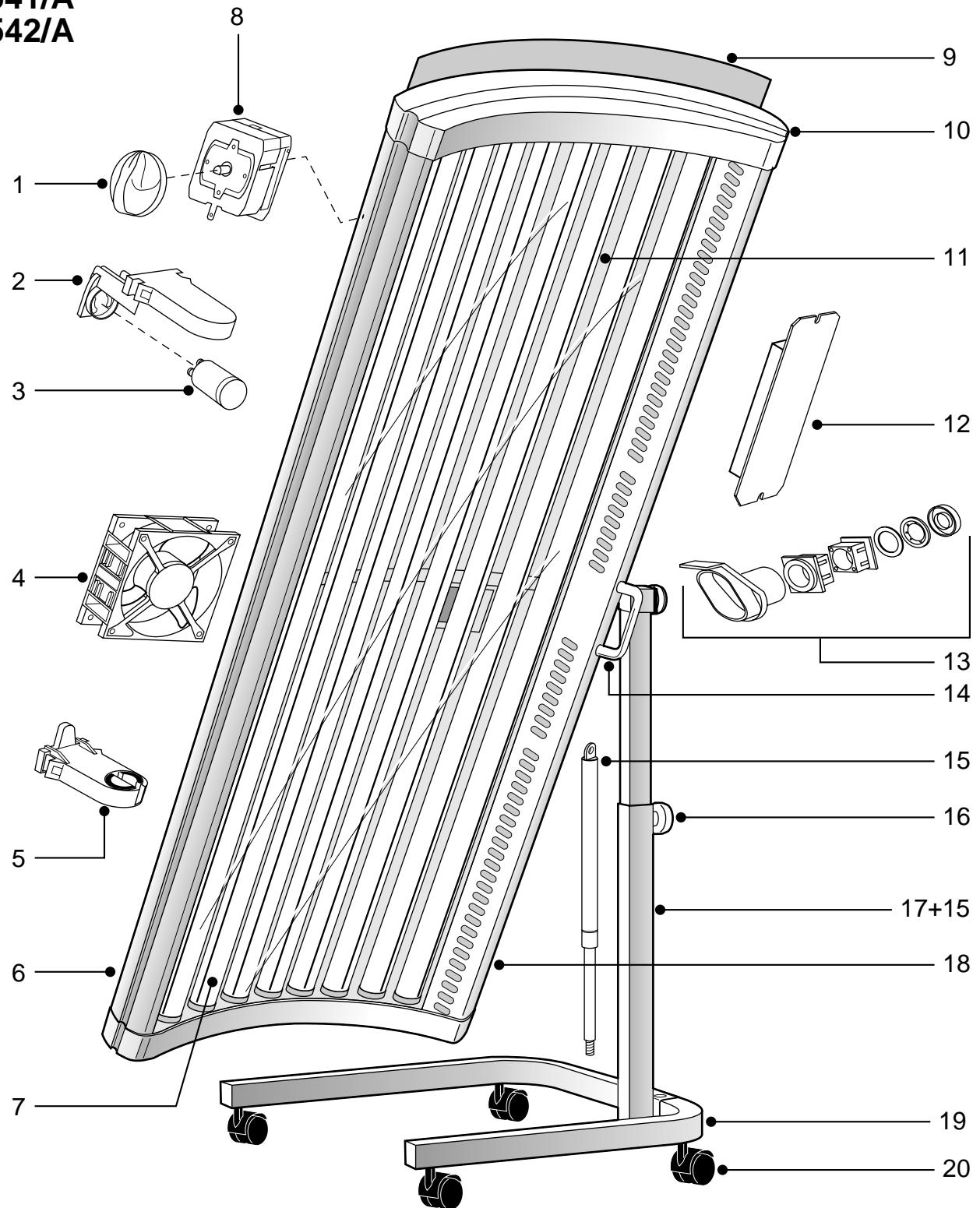

- | | | |
|----|----------------|---------------------|
| 1 | 4822 410 11079 | timer knob |
| 2 | 4822 255 10255 | lamp/starter holder |
| 3 | 4822 219 80258 | S12 starter |
| 4 | 4822 361 10747 | fan 230V |
| 5 | 4822 255 10254 | lamp holder |
| 6 | 9965 000 06405 | side panel |
| 7 | 4822 134 30014 | TL 100W/Cleo |
| 8 | 4822 349 40068 | timer 60 mins |
| 9 | 4822 442 00005 | cover |
| 10 | 4822 442 00006 | end cover |

- | | | |
|----|----------------|----------------------|
| 11 | 4822 466 10705 | acrylic plate |
| 12 | 4822 146 10344 | ballast 230V |
| 13 | 4822 520 10789 | bearing set |
| 14 | 9965 000 02280 | handgrip |
| 15 | 4822 529 10329 | gaspring |
| 16 | 4822 502 13999 | orn. screw |
| 17 | 9965 000 02732 | stand with gaspring |
| 18 | 9965 000 01865 | side panel with grip |
| 19 | 4822 462 11193 | U-shaped foot |
| 20 | 4822 528 10924 | swivel wheel |

- 4822 690 80147 HB072 prot. goggles