

Service
Service
Service

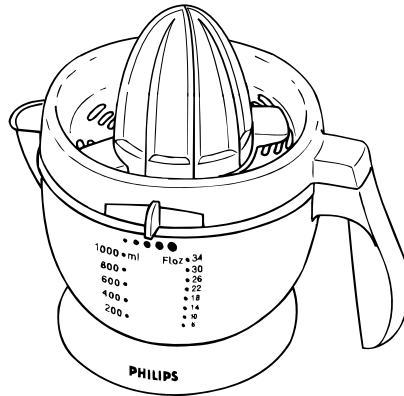

Philips Domestic Appliances and Personal Care

Service Manual

PRODUCT INFORMATION

Motor	:	Synchronous
Power	:	25 W
Cone speed	:	50 Hz - 54 r.p.m. 60 Hz - 65 r.p.m.
Cord length	:	1.2 m
Type no. on motor unit	:	HR 2790-92/GA
Colour	:	Green / Violet

SERVICE INFORMATION

- Drive shaft (item 6) can be pulled off.
- Components configuration on exploded view may differ from specific versions.
However, the actual components are discernable by code number.

This product meets the requirements regarding interference suppression on radio and TV.

After the product has been repaired, it should function properly and has to meet the safety requirements as officially laid down at this moment.

HR 2792/GA

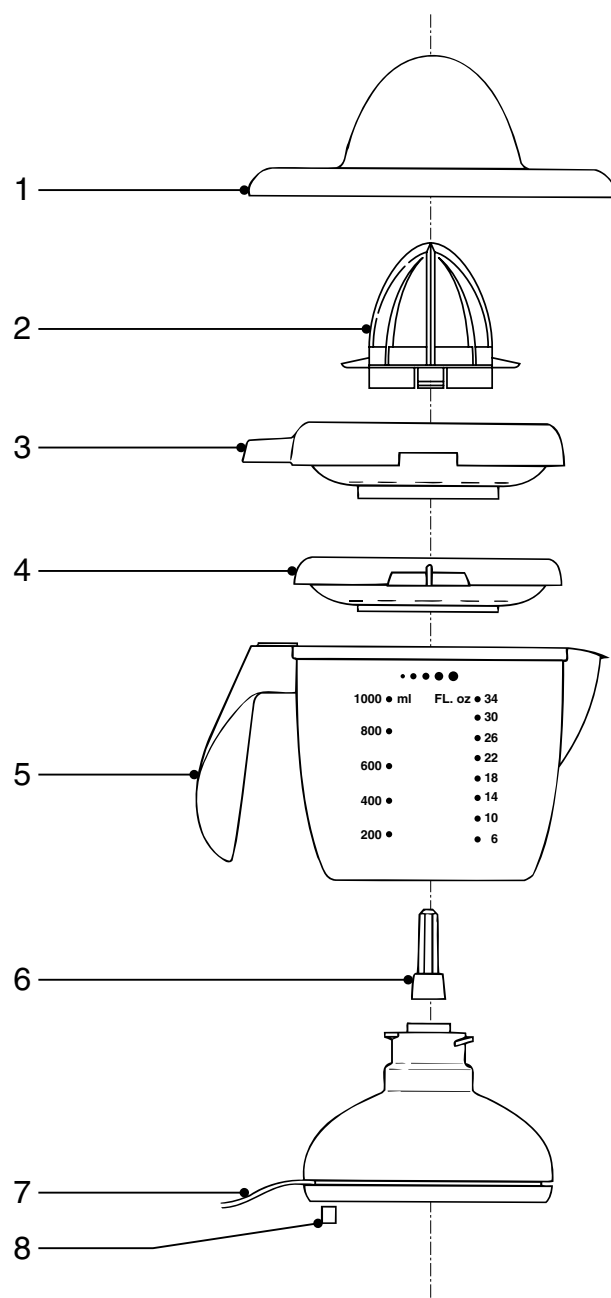

1	4203 065 62980	Dustcover	5	4203 065 62940	Container 1.0 l
2	4203 065 62970	Eco press cone	6	4203 065 62930	Spindle 1.0 l
3	4203 065 62950	Sieve 1	7	4822 321 10364	Mains cord
4	4203 065 62960	Sieve 2	8	4822 462 40374	Foot