

Philips Domestic Appliances and Personal Care

# Service Manual

## PRODUCT INFORMATION

Motor	:	Synchronous
Power	:	25 W
Cone speed	:	50 Hz - 54 r.p.m. 60 Hz - 65 r.p.m.
Cord length	:	1.2 m
Type no. on motor unit	:	HR2790-92/FA
Colour	:	Lilac

## SERVICE INFORMATION

- Drive shaft (item 6) can be pulled off.
- Components configuration on exploded view may differ from specific versions.  
However, the actual components are discernable by code number.

This product meets the requirements regarding interference suppression on radio and TV.

After the product has been repaired, it should function properly and has to meet the safety requirements as officially laid down at this moment.

# HR2792/FA

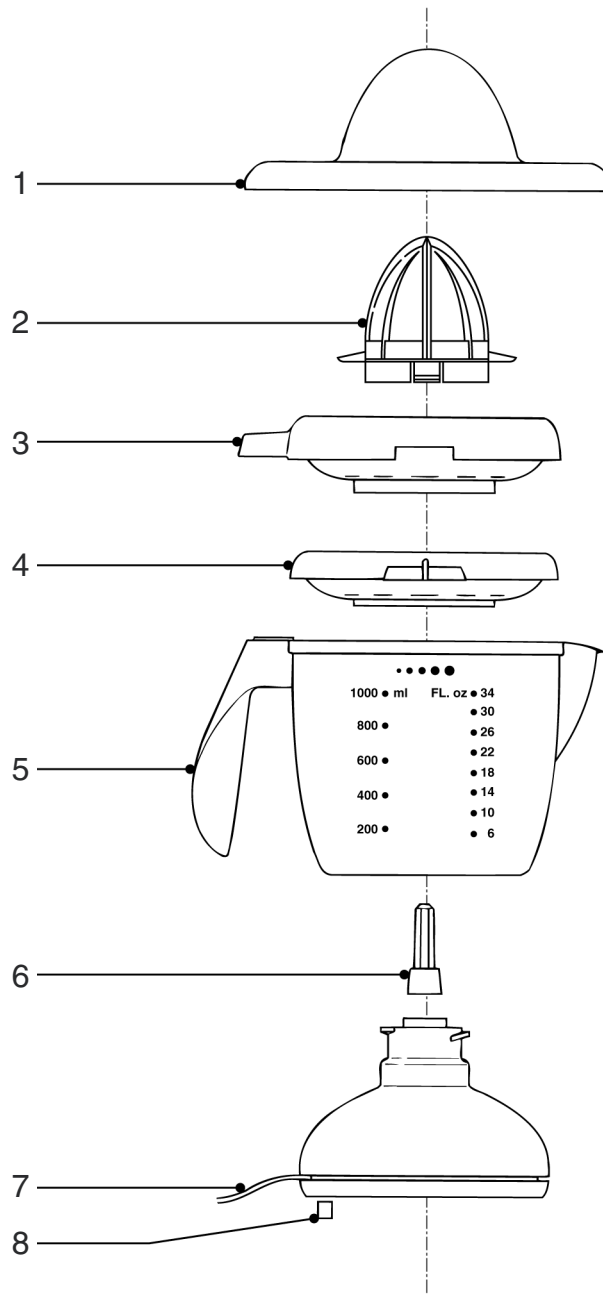

1	4203 065 62430	Dustcover	6	4203 065 62930	Spindle 1.0 l
2	4203 065 62440	Eco press cone	7	4822 321 10364	Mains cord
3	4203 065 62450	Sieve 1	8	4822 462 40374	Foot
4	4203 065 62460	Sieve 2	DFU	4203 064 07660	
5	4203 065 62470	Container 1.0 l			