

Service
Service
Service



Philips Domestic Appliances and Personal Care

ServiceManual

PRODUCT INFORMATION

Voltage	: 220 - 230 V, 240 V ; 50 - 60 Hz
Power consumption	: 18 Watts
Cool tip	: For easy use
Attachments	: Large curling tong for large rounded curls Small curling tong for tight rounded curls Slide over brush for soft curls and waves Spiral for ringlets and corkscrew effects
Crimper / Straightener	: For smoothing out waves and achieve a leek look For all-over or partial crimping effects
Cord length	: 1.8 metres

Product meets the requirements regarding interference suppression on radio and TV.

General:

For this air styler only the **spare parts mentioned below** will be available in the after -sales period.

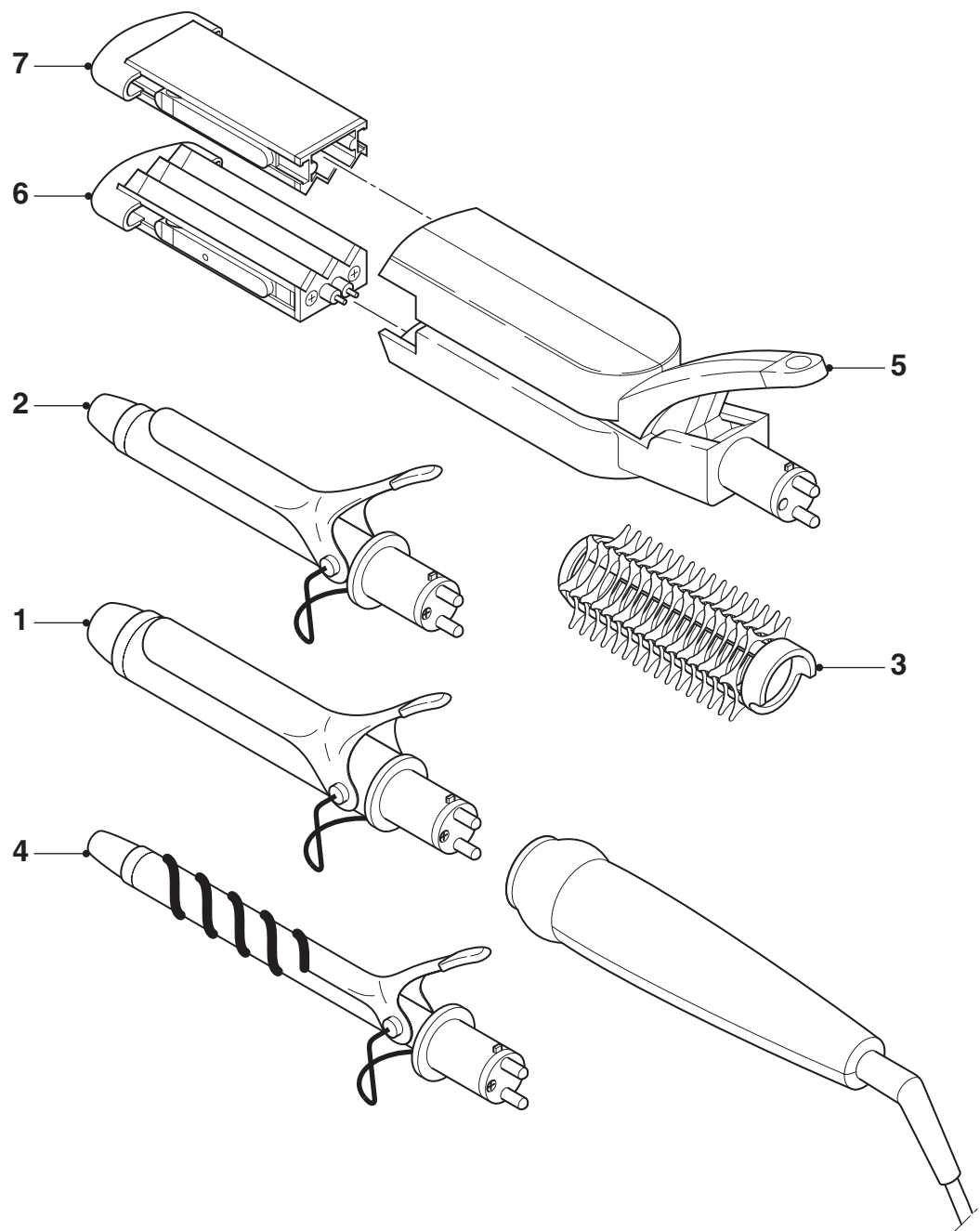

Pos.	Description	Service code
1	Long curling tong	9965 000 10779
2	Small curling tong	9965 000 10780
3	Slide over brush	9965 000 10781
4	Spiral	9965 000 10782
5	Straightener / Crimper (including pos. 6 + 7)	9965 000 10783
6	Crimper / Straightener	9965 000 10784
7	Crimper / Straightener	9965 000 10785