

Service  
Service  
Service



Philips Domestic Appliances and Personal Care

# Service Manual

## PRODUCT INFORMATION

Rechargeable batteries	: 3 x 1.2V
Transformer AC / AC	: 230 V / 7 V AC - 400 mA
Charge indicator	: LED
Dust capacity	: 0.3 Liter
Liquid suction capacity	: 0.1 Liter
Switch positions	: 0 - 1 - 2
Weight	: 0.75 kg
Dimensions	: 16.7 x 40.4 x 11.2 cm
Cord length	: 1.8 m
Air flow	: 0.48 m <sup>3</sup> / minute

## SERVICE INFORMATION

- The dust container and wall holder are all interchangeable for all versions, only with color difference.
- Washable permanent filter is available under type number FC 8036 (8838 036 01010).
- The rechargeable batteries contained substances, which may pollute the environment. Dispose unused cells at especially assigned places.
- If a repair has been executed, ensure that all the functions of the appliance are working correctly.
- Operating time is defined as the time it takes to discharge 50 % of the nominal capacity of the batteries.

	Battery type	Colour setting	Operation time (fully charged)
FC 6067/01	NiCd 3 x 1600 mA	Ivory / Pearl blue	> 8 minutes
FC 6067/02	NiMH 3 x 2200 mA	Ivory / Pearl blue	> 11 minutes

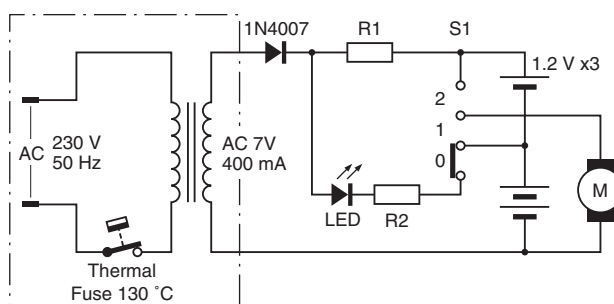

This product meets the requirements regarding interference suppression on radio and TV.

After the product has been repaired, it should function properly and has to meet the safety requirements as officially laid down at this moment.

# FC 6067

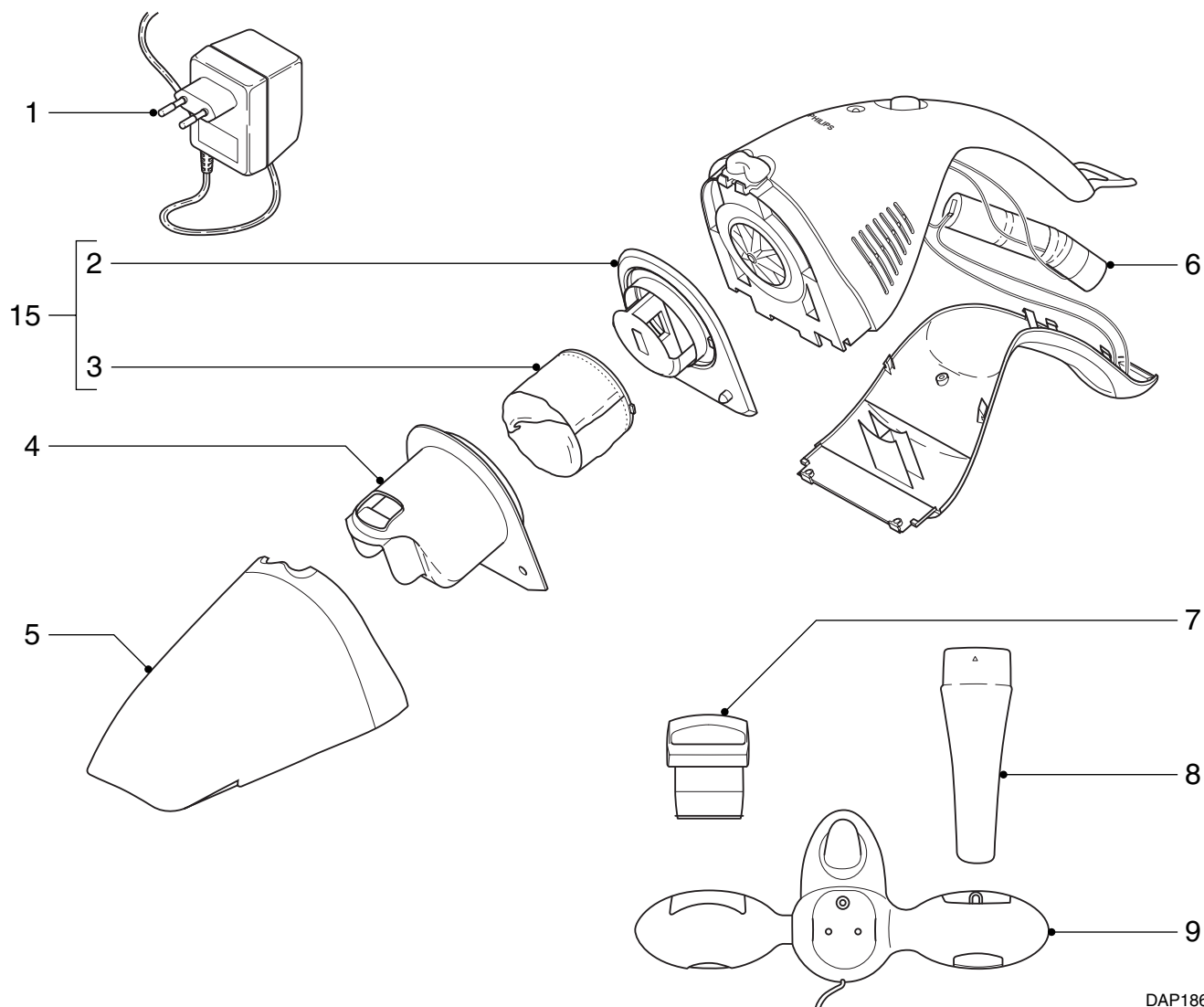

DAP1867

Item	Description		Service
1	Adapter - EU		9965 000 06425
	Adapter - UK		9965 000 06426
	Adapter - Taiwan		9965 000 06427
	Adapter - Korea		9965 000 06428
2	Filter holder assy		9965 000 10796
3	Filter dry/wet		9965 000 10795
4	Deflector		9965 000 10797
5	Dust container		9965 000 10794
6	Battery	NiCd	9965 000 11452
	Battery	NiMH	Not available
7	Squeegee		9965 000 10799
8	Crevice tool		9965 000 10793
9	Wall holder		9965 000 10798
15	Filter assy		9965 000 13718
	Dry/wet filter set (2 pcs)		8838 036 01010