

Service
Service
Service



Philips Domestic Appliances and Personal Care

Service Manual

INTRODUCTION:

The Colour Precise is designed to permanent colour the hair easier, faster and more precise.

The appliance is based on the "DiffusionControl System" a combination of a disposable colour diffuser and the moving disk on the appliance.

The special design of the colour diffuser allows to easily distribute the hair colour right down to the roots.

The ergonomics of the Color Precise allow to reach all parts of the head, even the back of the head.

One can permanent colour the hair in less than 4 minutes.

MAINTENANCE TIPS

- Do not use a Color Diffuser for more than one time.
- Do not store the Color Diffuser with colorant in the appliance after use.
Remove and dispose of it safely immediately.
- Do not clean the Color Precise under the tap.
Clean the Color Precise with a dry cloth.
If necessary you can use a moist cloth

PRODUCT INFORMATION:

Voltage	: 3 volt
Required batteries	: 2 x AA Alkaline batteries, 1.5 V
Colour appliance	: Lilac
Colour attachments	: Milky white

Product meets the requirements regarding interference suppression on radio and TV.

PARTLIST

For this HP 455 I color styler, only **the accessories mentioned below** will be available for service in the after sales period.

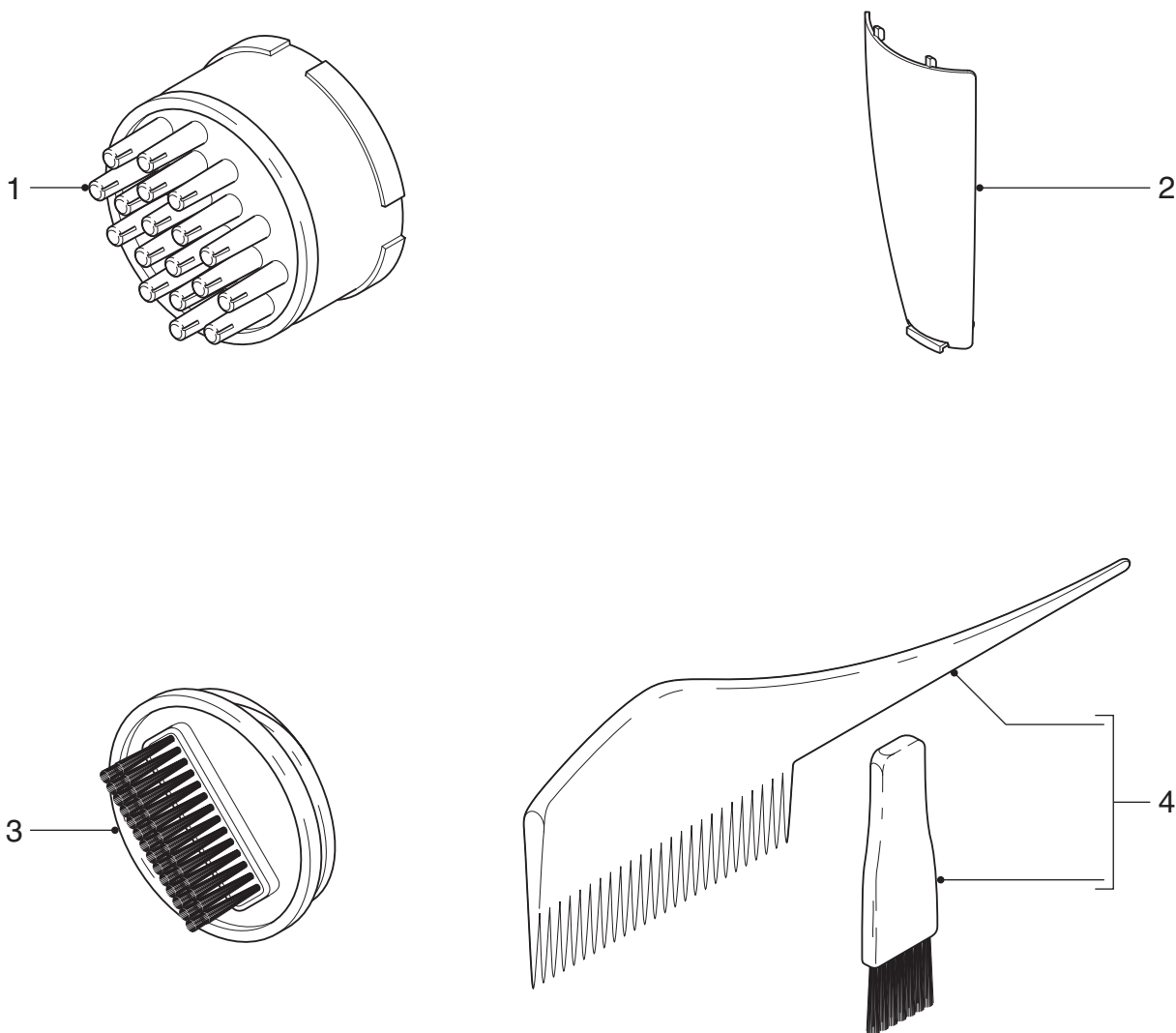

Pos.	Description	Service code
1	Colour diffuser (x 2 pcs packed)	8844 951 00021
2	Cover battery compartment	4239 026 05800
3	Brush plug packed	4239 021 14790
4	Comb brush packed	4239 021 14750