



Philips Domestic Appliances and Personal Care

Service Manual

PRODUCT INFORMATION

Features

- Color : Greyish Lilac
- Ceralon soleplate
- Steam output (25 grams/min)
- Shot of Steam (45 grams/min)
- Vertical Shot of Steam
- 2 steam level
- Spray feature
- Tank capacity (250 ml)
- Cord length (1.8 m)
- 180 degrees swivel
- Integrated calc-clean feature
- Integrated cord winder feature

Safety Information

- This product meets the requirements regarding interference suppression on radio and TV.
- After the product has been repaired, it should function properly and has to meet the safety requirements and legal regulations as officially laid down at this moment.

TECHNICAL INFORMATION

Voltage	: 230 - 240 V
Frequency	: 50 - 60 Hz
Power	: 1450 - 1750 W
Dimension (F-box)	: 306 (L) x 128 (W) x 157 (H) mm
Product weight	: 1.2 kg

Water Advice

Suitable for tap water use. Advice to mix with equal portion of distilled water or use only distilled water if the tap water is very hard.

Ceralon Soleplate

This Ceralon soleplate glides smoothly, is non-stick & very easy to clean. Ceralon has a high scratch resistance and its durability is competitive in the market.

Shot of Steam

The shot of steam features a steam boost (45grams/min) that helps to remove stubborn wrinkles easily.

Vertical Shot of Steam

This features a steam boost in vertical position to remove wrinkles in hanging garments.

Integrated Calc-clean

This ensures a longer life time of the iron and to allow the use of normal tap water.

BACKPLATE 1**SWIVEL 2****CORDSET 3**

- Remove Screw A 1x
- Remove Backplate 1
- Remove Screw B 2x (cord clamp)

OPERATION KNOB 4**DOSING UNIT 5****INLAY 6****PUMP 8****NOZZLE 9**

- Remove Screw A 1x
- Remove Backplate 1
- Remove Screw B 2x (cord clamp)
- Remove Cord set 3
- Remove Dosing unit 5
- Remove Screw D 1x
- Remove Inlay 6
- Remove Operation knob 4

DIAL 10**RATTLE SPRING 11****TANK SET 12****LAMP ASSEMBLY 13****LAMP HOLDER 18**

- Remove Screw A 1x
- Remove Backplate 1
- Remove Screw B 2x (cord clamp)
- Remove Cord set 3
- Remove Dosing unit 5
- Remove Screw D 1x
- Remove Inlay 6
- Remove Operation knob 4
- Remove Screw C 3x

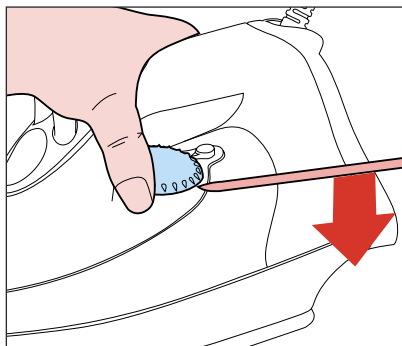
**COVER 14****THERMOSTAT BUSH 15****SOLEPLATE 16****SEAL 102, 103**

- Remove Screw A 1x
- Remove Backplate 1
- Remove Screw B 2x (cord clamp)
- Remove Cord set 3
- Remove Dosing unit 5
- Remove Screw D 1x
- Remove Inlay 6
- Remove Operation knob 4
- Remove Screw C 3x
- Remove Screw E 3x
- Remove Cover 14

REPAIR INSTRUCTIONS

- Due to the high voltage of the iron, ONLY the specified cordsets must be used.
- Thermostat that is fitted to the soleplate (Pos 16) was pre-adjusted by the suppliers and secured by glue. To avoid mal-function of the iron, NEVER re-adjust the thermostat.
- No information about the type number and voltage is stamped onto the typeplate. When replacing the cover (typeplate is at the bottom), engrave at least the type number & voltage on the typeplate with a sharp object.
- For easy removal of inlay, unlock catch behind, then twist sideways by holding the central section of the inlay.

OPTIONAL (accessories)

- No specific issues

Pos	Service code	Description	Consist of
1	4239 026 12410	Backplate	
2	4239 026 11320	Swivel	
3	4239 000 08500	Cordset - EU	
4	4239 026 13060	Operation knob - Spray (Lilac)	104
	4239 026 13070	Operation knob - SOS (Lilac)	105
5	4239 021 17170	Dosing unit - non extra steam	
6	4239 026 12510	Inlay	
7	4239 015 54210	Sealing - Tank top seal	101
	4239 015 55070	Sealing - Cover seal	102
	4239 015 51450	Sealing - SOS seal	103
8	4239 020 90560	Pump	
9	4239 025 99230	Nozzle	
10	4239 021 15580	Dial - French/Dutch text	
	4239 021 20900	Dial - English text	
11	4239 026 12460	Plastic rattle spring	
12	4239 021 15820	Tank set - SOS (Lilac)	
13	4239 021 03140	Lamp assembly	
14	4239 026 12860	Cover	
15	4239 026 13220	Thermostat bush	
16	4239 021 15290	Soleplate assembly - 230 V	
17	4239 026 05570	Lamp cover	
18	4239 026 12400	Lamp holder	

