



Philips Domestic Appliances and Personal Care

# Service Manual

## PRODUCT INFORMATION

### Features

- Color : Aqua Purple
- Stainless steel soleplate
- Steam output (28 grams/min)
- Shot of Steam (60 grams/min)
- Vertical Shot of Steam
- 3 steam level
- Spray feature
- Tank capacity (250 ml)
- Cord length (1.8 m)
- 360 degrees swivel
- Integrated calc-clean feature
- Integrated cord winder feature
- Filling door
- Drip Stop feature

### Safety Information

- This product meets the requirements regarding interference suppression on radio and TV.
- After the product has been repaired, it should function properly and has to meet the safety requirements and legal regulations as officially laid down at this moment.

## TECHNICAL INFORMATION

Voltage	: 230 - 240 V
Frequency	: 50 - 60 Hz
Power	: 1500 - 1800 W
Dimension (F-box)	: 306 (L) x 128 (W) x 157 (H) mm
Product weight	: 1.2 kg

### Water Advice

Suitable for tap water use. Advice to mix with equal portion of distilled water or use only distilled water if the tap water is very hard.

### Stainless Steel Soleplate

The stainless steel soleplate glides smoothly & very easy to clean. Stainless steel has a high scratch resistance and its durability is very competitive in the market.

### Shot of Steam

The shot of steam features a steam boost (60 grams/min) that helps to remove stubborn wrinkles easily.

### Vertical Shot of Steam

This features a steam boost in vertical position to remove wrinkles in hanging garments.

### Integrated Calc-clean

This ensures a longer life time of the iron and to allow the use of normal tap water.

### Drip Stop

Water is only released into steam chamber via the tank valve when the soleplate temperature is high enough. If the temperature is too low, the tank valve is closed by means of a bi-metal disc. This prevents water from dripping onto garment.

**BACKPLATE 1****BALL SWIVEL 2****SWIVEL PLATFORM 20****CORDSET 3**

- Remove Screw A 1x
- Remove Backplate 1
- Remove Screw B 2x (cord clamp)

**OPERATION KNOB 4****DOSING UNIT 5****INLAY 6****FILLING DOOR 19****PUMP 8****NOZZLE 9**

- Remove Screw A 1x
- Remove Backplate 1
- Remove Screw B 2x (cord clamp)
- Remove Cord set 3
- Remove Dosing unit 5
- Remove Screw D 1x
- Remove Inlay 6
- Remove Operation knob 4

**DIAL 10****RATTLE SPRING 11****TANK SET 12****TANK SEAL 106****LAMP ASSEMBLY 13****LAMP HOLDER 18**

- Remove Screw A 1x
- Remove Backplate 1
- Remove Screw B 2x (cord clamp)
- Remove Cord set 3
- Remove Dosing unit 5
- Remove Screw D 1x
- Remove Inlay 6
- Remove Operation knob 4
- Remove Screw C 3x

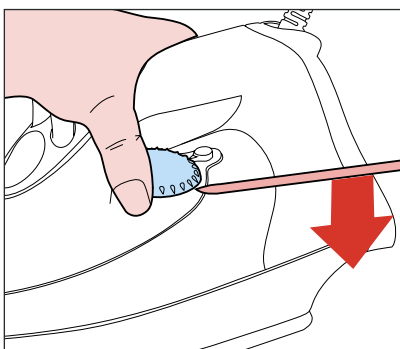
**COVER 14****THERMOSTAT BUSH 15****SOLEPLATE 16****SEAL 102, 103**

- Remove Screw A 1x
- Remove Backplate 1
- Remove Screw B 2x (cord clamp)
- Remove Cord set 3
- Remove Dosing unit 5
- Remove Screw D 1x
- Remove Inlay 6
- Remove Operation knob 4
- Remove Screw C 3x
- Remove Tank set 12
- Remove Screw E 3x
- Remove Cover 14

**REPAIR INSTRUCTIONS**

- Due to the high voltage of the iron, ONLY the specified cordsets must be used.
- Thermostat that is fitted to the soleplate (Pos 16) was pre-adjusted by the suppliers and secured by glue. To avoid mal-function of the iron, NEVER re-adjust the thermostat.
- No information about the type number and voltage is stamped onto the typeplate. When replacing the cover (typeplate is at the bottom), engrave at least the type number & voltage on the typeplate with a sharp object.
- Part number 107, 108 cannot be ordered separately.

**OPTIONAL (accessories)**

- No specific issues

Pos	Service code	Description	Consist of
1	4239 026 12420	Backplate	
2	4239 026 12430	Ball swivel	
3	4239 000 08500	Cordset - EU	
4	4239 026 12990	Operation knob - Spray (Purple)	104
	4239 026 13000	Operation knob - SOS (Purple)	105
5	4239 021 17020	Dosing unit - non extra steam	
6	4239 026 14000	Inlay	
7	4239 015 54210	Sealing - Tank top seal	101
	4239 015 55070	Sealing - Cover seal	102
	4239 015 51450	Sealing - SOS seal	103
	4239 015 54400	Sealing - Tank seal	106
8	4239 020 90560	Pump	
9	4239 025 99230	Nozzle	
10	4239 021 15850	Dial - French/Dutch text	
	4239 021 20910	Dial	
11	4239 026 12460	Plastic rattle spring	
12	4239 021 15640	Tank set - SOS (Purple)	107
13	4239 021 03140	Lamp assembly	
14	4239 026 12390	Cover	
15	4239 026 13220	Thermostat bush	
16	4239 021 15320	Soleplate assembly - 230 V	108
17	4239 026 05570	Lamp cover	
18	4239 026 12400	Lamp holder	
19	4239 021 17050	Filling door assembly (Purple)	
20	4239 025 92220	Swivel platform	

