



Philips Domestic Appliances and Personal Care

# Service Manual

## PRODUCT INFORMATION

- This solarium is especially intended for the tanning of the face.
- The UVA-source consists of 3x2 series connected TL's.
- The radiation distance is 10 cm or less.
- In connection with this small distance the advice is to wear protecting goggles during the cure.

## TECHNICAL INFORMATION

- |                      |                           |
|----------------------|---------------------------|
| - Input              | : 105 W                   |
| - UVA-source         | : 6 x TL CLEO 15W         |
| - Radiation area     | : 20 x 26 cm              |
| - Radiation distance | : 10 cm                   |
| - Starter            | : 6 x S2                  |
| - Ballast            | : 3 x 30 W                |
| - Timer              | : 60 min./Diehl           |
| - Protecting goggles | : 4822 690 80123          |
| - Output UVX36 meter | : >4.0 mW/cm <sup>2</sup> |
| - SAP coding         | : HB185                   |

## DISASSEMBLY AND ASSEMBLY

- After the screws (item A) have been loosened the cover (item 1) can be removed.
- Starter(s) and lamp(s) can be replaced now.

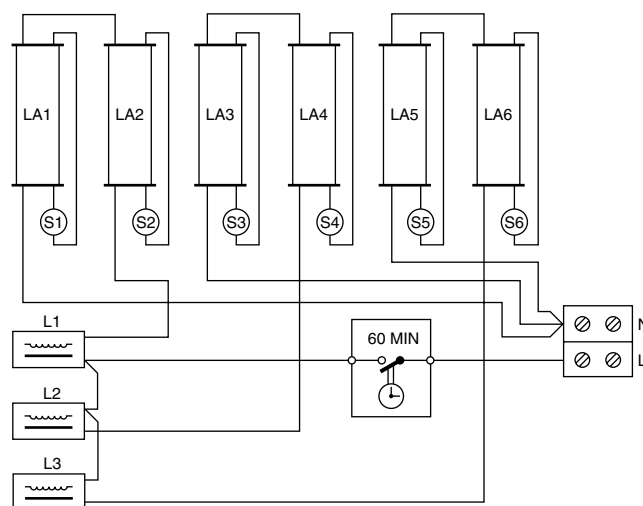

## REPAIR INSTRUCTIONS

- If one lamp or starter is defective 2 lamps will not burn because of the series connection.  
By changing it can be found which lamp or starter is defective.
- When the reflector has been removed the internal wiring can be checked.
- For the replacement of a ballast the tubular staple must be drilled out.  
The new ballast can be fastened with a M4 bolt and nut.

## MISCELLANEOUS

- No specific issues.

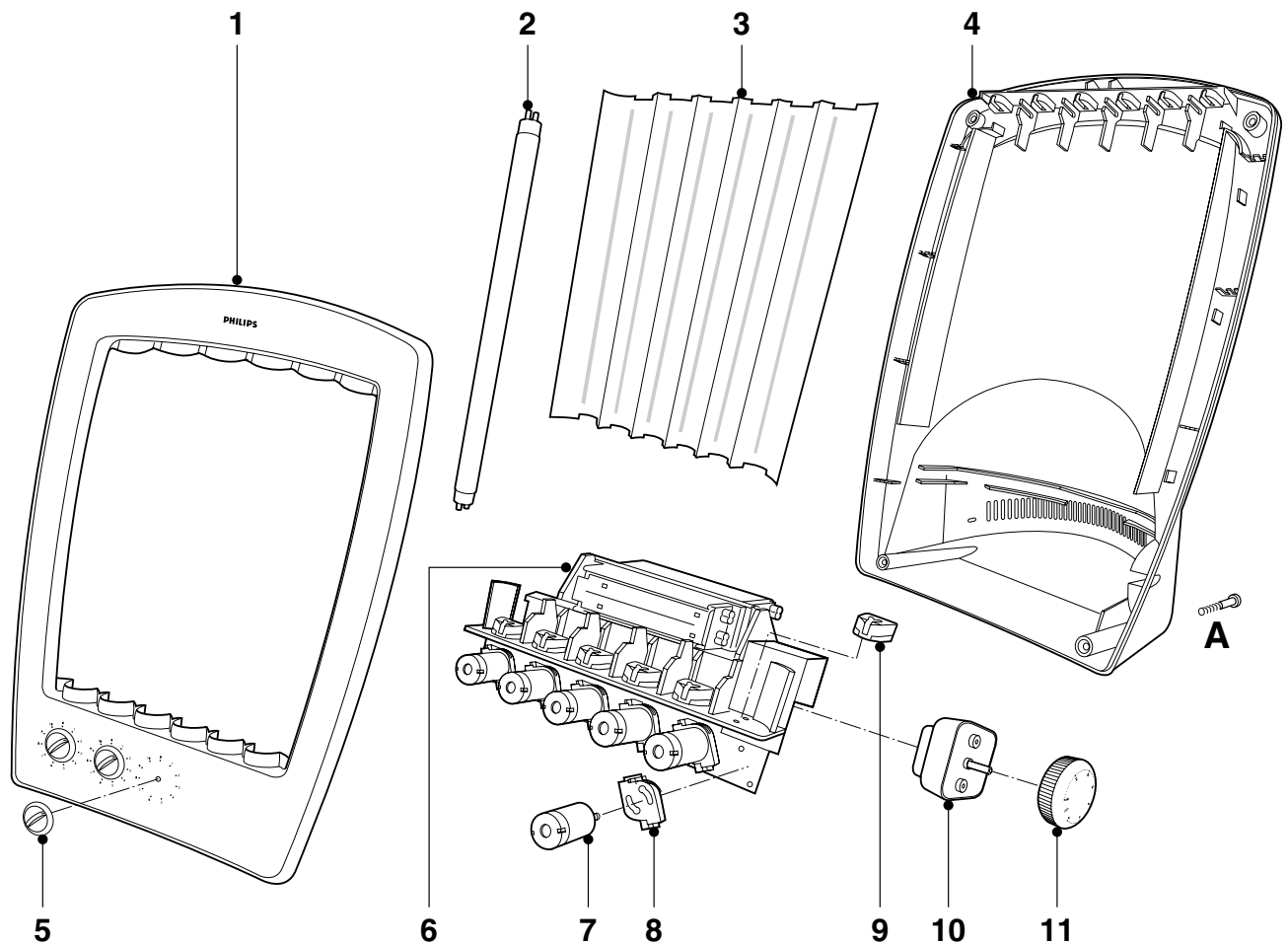

Item	Service code	Description
1	9965 000 17138	Cover
2	4822 134 30026	TL CLEO 15 W
3	9965 000 17160	Reflector
4	9965 000 17137	Housing
5	9965 000 06240	Memo knob
6	4822 142 60359	Ballast 30 W / 230 V
7	5322 219 80597	Starter S2
8	4822 255 10153	Starter holder
9	4822 255 10182	Lamp holder
10	4822 349 40073	Timer
11	9965 000 06236	Timer knob