

Service
Service
Service

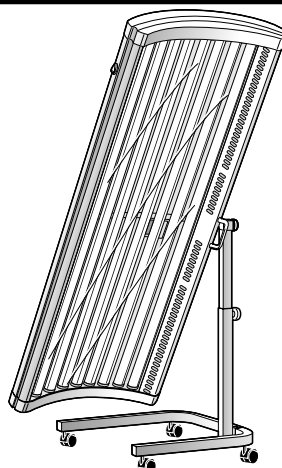

Domestic Appliances and Personal Care

Service Manual 4822 729 21763 is
herewith cancelled.

Service Manual

SAP coding 8843 544 99999

PRODUCT INFORMATION

UVA lamps	: 10 x TL100W/Cleo
	: 4 x TL 15W/Cleo
Input power	: approx. 1160W
Starter	: 10 x S12
	: 4 x S2
Ballast	: 10 x 100W/230V
	: 2 x 30W
Timer	: 60 mins Eaton
Radiation area	: 170 x 56 cm
Radiation distance	: 20 cm
Height adjustment	: between 66-96 cm
Protecting goggles	: HB071 - 4822 690 80123
Output UVX36 meter	: >4.6 mW/cm ² at 20 cm

HINTS FOR REPAIRS

- By interchanging it can be found out whether starters, lamps or ballasts are defective.
If they are not, the internal wiring is to be checked, especially that on the tube holders.
- The snap-on connections of the wiring can be unlocked with a paper clip.
- The quick blackening of a tube-end points to a defective starter or a wiring fault.
- **Disassembly of radiation part**
Remove end cover (item 11, 2x).
Remove cover (item 10) and acrylic plate (item 13).
For removal of ballast or fan the pop rivets must be drilled out.
New parts have to be fixed with pop rivets 4.8 mm or blind-rivetting nuts M3 (no service items).

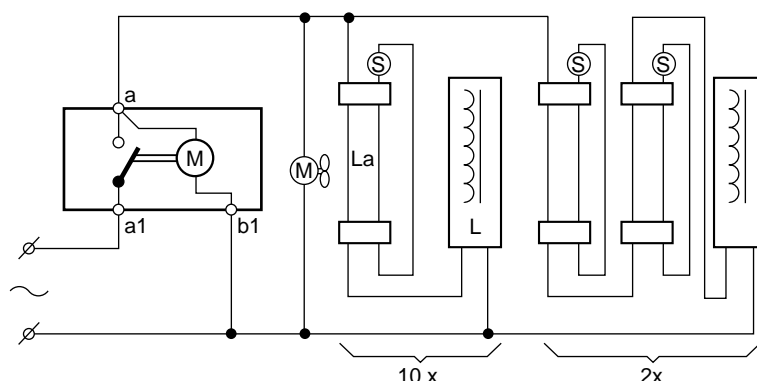

- Disassembly of gasspring (item 18)

Put solarium in highest position.
Fasten ornamental screw (item 19)
Now turn the stand and the radiation unit through so far that the legs of the stand and the radiation unit rest on the floor.
Remove the nut inside the stand tube.
Remove the ornamental screw and unlock the plastic guide block.
Separate the inner and outer stand part.
Remove the ornamental prop and the spring clip at the inner side of the stand and lift the pin out.
The gasspring can be taken out now.
Note: a new gasspring comes with plastic guide block, spring clip and ornamental prop.

Disassembly of hinge (item 15)

Remove the ornamental prop, spring clip and plastic ring.
Polish the shaft with abrasive paper to make the removal of guide blocks easier.
On assembly see to it that the cams of the spring clip rest in the groove on the shaft.



PHILIPS

HB 544/A

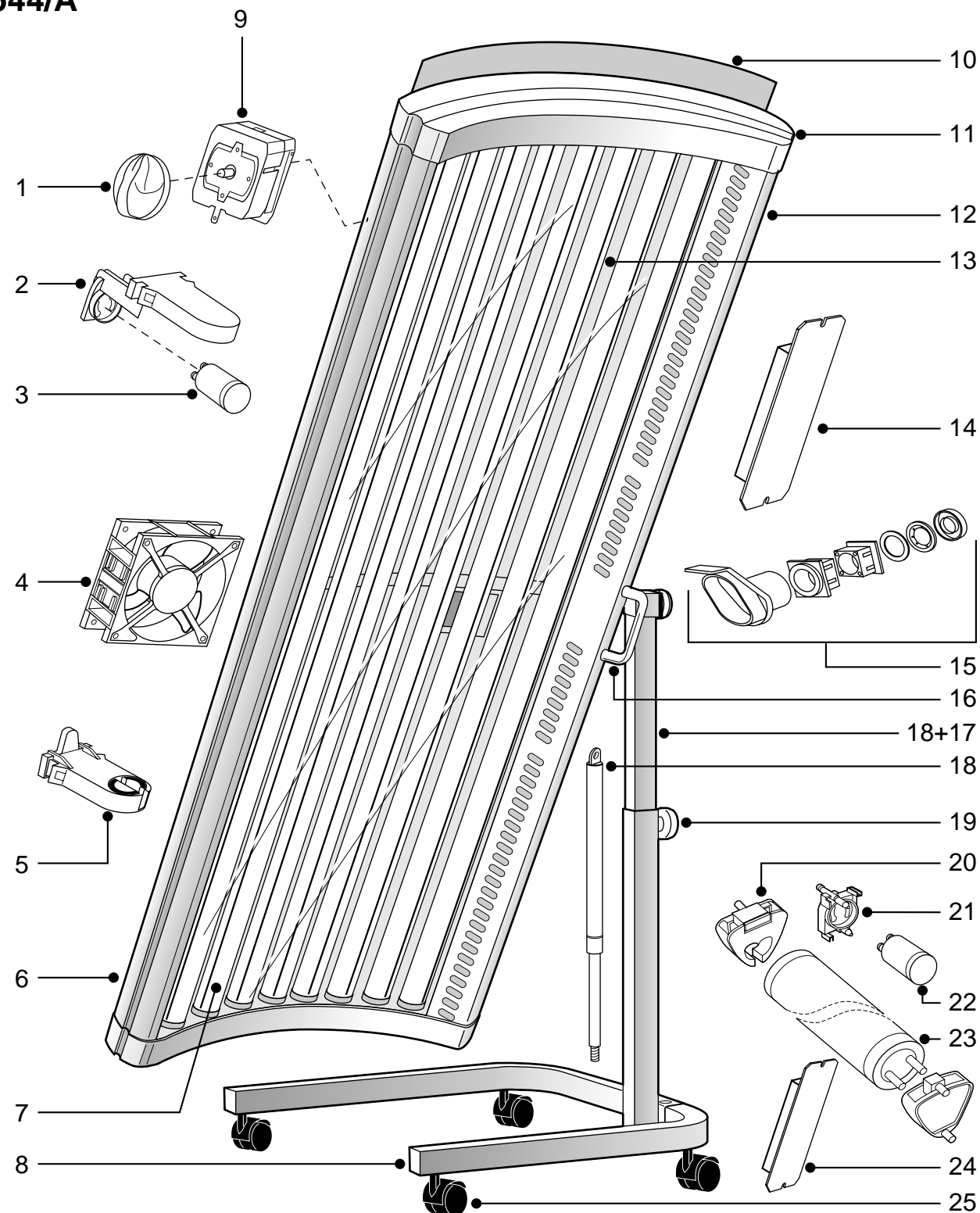

- 1 4822 410 11079 timer knob
- 2 4822 255 10255 lamp/starter holder
- 3 4822 219 80258 S12 starter
- 4 4822 361 10966 fan 230V
- 5 4822 255 10254 lamp holder
- 6 9965 000 06405 side panel
- 7 4822 134 30014 TL 100W/Cleo
- 8 4822 462 11193 U-shaped foot
- 9 4822 349 40068 timer 60 mins
- 10 4822 441 11963 cover

- 16 9965 000 02280 handgrip
- 17 9965 000 02732 stand with gaspring
- 18 4822 529 10329 gaspring
- 19 4822 502 13999 orn. screw
- 20 4822 255 10182 lamp holder

- 21 4822 255 10153 starter holder
- 22 5322 219 80597 S2 starter
- 23 4822 134 30026 TL 15W/Cleo
- 24 4822 142 60359 ballast 230V/30W
- 25 4822 528 10924 swivel wheel

- 11 4822 442 00006 end cover
- 12 9965 000 01865 side panel with grip
- 13 4822 466 10705 acrylic plate
- 14 4822 146 10344 ballast 230V/100W
- 15 4822 520 10789 bearing set

4822 690 80147 HB072 prot. goggles